

HS, JS, LS, PS-2

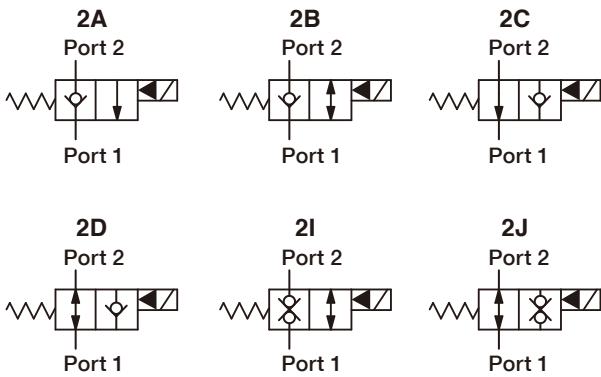

SYMBOLS



ORDER CODES

LS - **2A** - **16** - **A1**

1 2 3 4

1 ▶ Cavity	HS	T082
	JS	T102
	LS	T122
	PS	T162
2 ▶ Type of Valve	2A, 2B, 2C, 2D, 2I, 2J (Please refer to the symbol list.)	
	16, 19	
3 ▶ Tube Diameter	16, 19	
4 ▶ Power Source	A1	RAC110V
	A2	RAC220V
	D1	DC12V
	D2	DC24V

MODEL SPEC.

Model	Cavity	Capacity (l/min)	Max. Pressure (bar)	Installation Torque (Nm)	Weight (kg)
HS-2A-16	T082	28	250	39/51	0.41
HS-2B-16	T082	28	250	39/51	0.41
HS-2C-16	T082	28	250	39/51	0.41
HS-2D-16	T082	30	250	39/51	0.41
HS-2J-16	T082	12	250	39/51	0.41
JS-2A-16	T102	50	250	39/51	0.43
JS-2B-16	T102	50	250	39/51	0.43
JS-2C-16	T102	50	250	39/51	0.43
JS-2D-16	T102	55	250	39/51	0.46
JS-2I-16	T102	20	250	39/51	0.45
HS-2J-16	T082	12	250	39/51	0.41

MODEL SPEC.

Model	Cavity	Capacity (l/min)	Max. Pressure (bar)	Installation Torque (Nm)	Weight (kg)
LS-2A-16	T122	100	250	39/51	0.53
LS-2B-16	T122	100	250	39/51	0.53
LS-2C-16	T122	100	250	39/51	0.56
LS-2D-16	T122	105	250	39/51	0.56
LS-2I-16	T122	40	250	39/51	0.56
PS-2A-19	T162	150	250	39/51	0.62
PS-2B-19	T162	150	250	39/51	0.62
PS-2C-19	T162	150	250	39/51	0.67
PS-2D-19	T162	150	250	39/51	0.67
PS-2I-19	T162	60	250	39/51	0.67

DIMENSION

(UNIT : mm)

► HS-2*

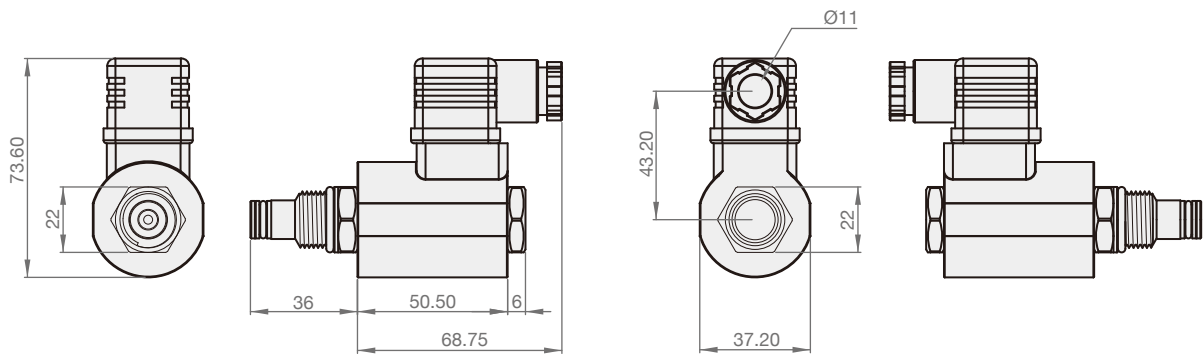

► JS-2*

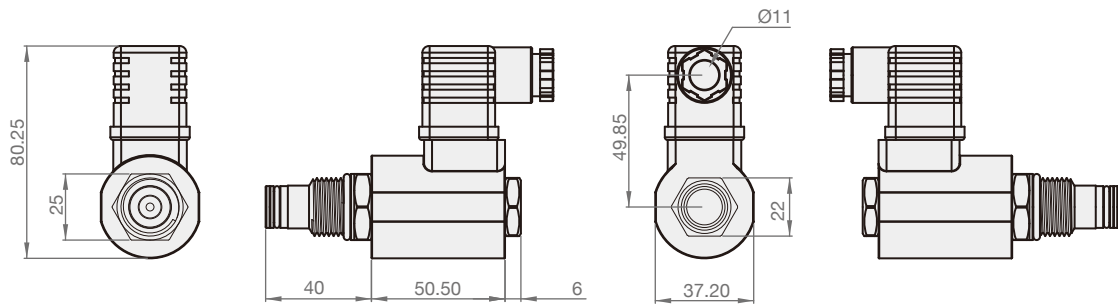

► LS-2*

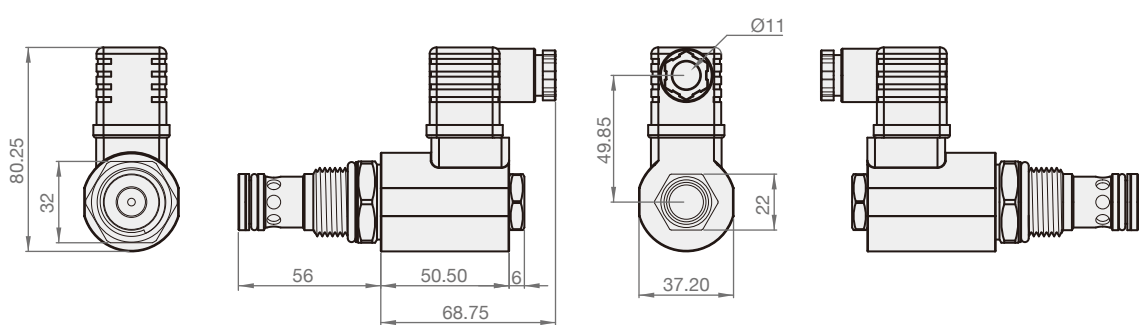

► PS-2*

